

**BE PART OF ONE OF THE FASTEST GROWING COMMUNITIES IN  
ST. LOUIS COUNTY . . . GROVER, MISSOURI**

*Wildwood*



**SHOULDN'T YOUR BUSINESS BE LOCATED HERE?**

**MAIN STREET PLAZA**

16924 Manchester Road  
Grover, Missouri 63040

*Wildwood*  
**Office/Retail For Lease**

**1,170 Sq. Ft. to 10,900 Sq. Ft.**

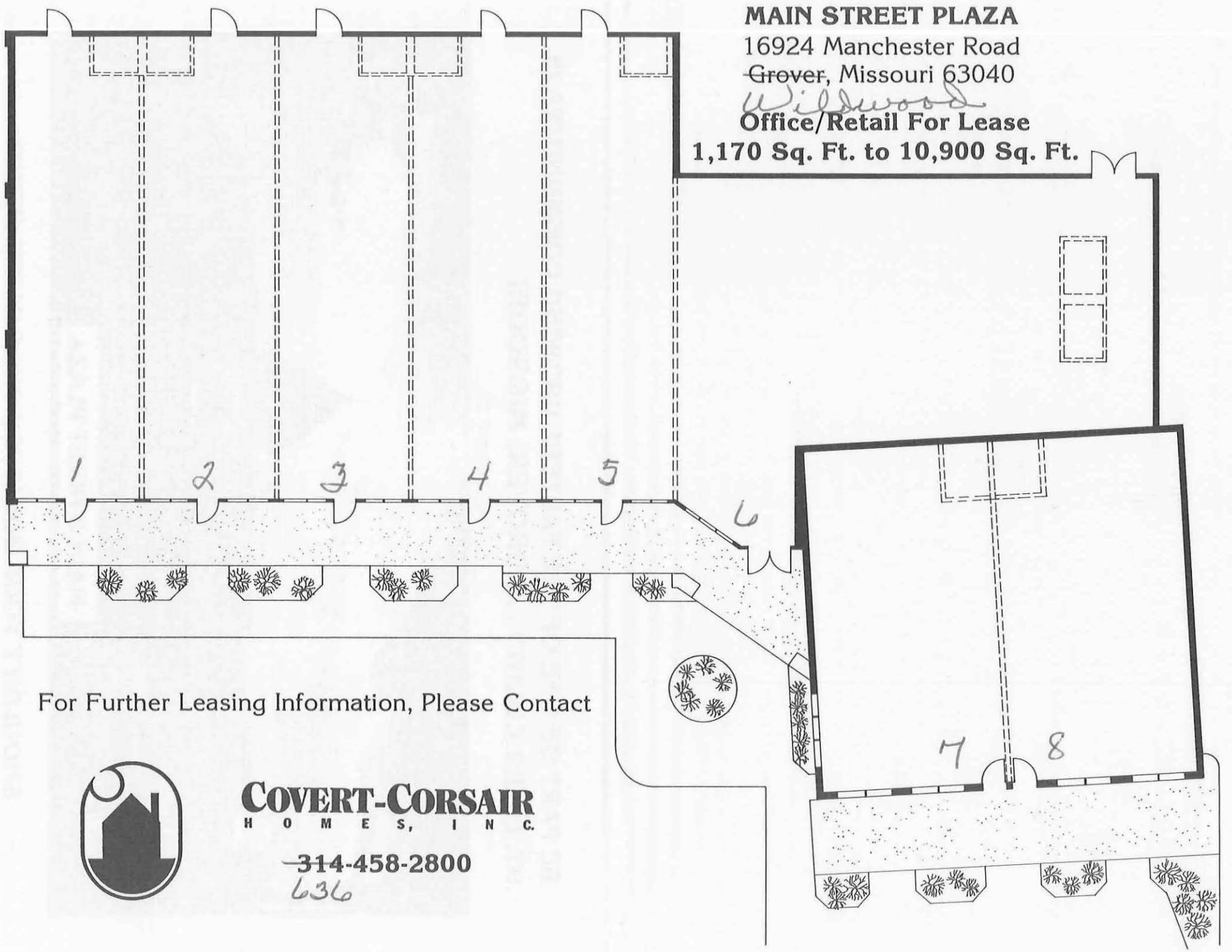

For Further Leasing Information, Please Contact



**COVERT-CORSAIR**  
H O M E S, I N C.

**314-458-2800**  
*636*